

FOLDING DOOR: ASSEMBLY INSTRUCTION

SERIES 1200 WITH MAGNETIC CLOSING

Version 1.0 (2018-10-01)

3.03.1.c

Assembly  easy medium difficult

Subject to technical changes.

raumplus[®]

CONTENT AND TOOLS

CONTENT:

Content and tools	page	02
Product information	page	03
Accessories	page	05
Exploded drawing	page	06
Cutting dimensions	page	07
Detail drawings	page	08
Assembly instruction	page	10
Order sheet	page	12



The working steps described in this instruction are exclusively valid for the folding door »DIN left«. The assembly for the folding door »DIN right« is to be carried out mirror-inverted – with special attention to page 9.

TOOLS:

(without claim of completeness)

- (Percussion) drilling machine
- Steel drill set
- Cordless screwdriver
- Aluminium saw
- Allen key set
- Water level
- Rubber mallet
- Straight edge



VERSION INFORMATION:











Version 1.0 Product launch

PRODUCT INFORMATION

GENERAL INFORMATION: Preparation

- This manual is part of the product and describes the safe and proper installation of the system. Please read the instructions carefully before installation.
- Please note that the assembly should only be done by qualified and trained staff in strict compliance with all details indicated in this document. Improper installation in variation from manufacturer's specification may cause defects and danger, thus endangering the safe fixing of the product as well as the safety of the prospective user. The liability of the manufacturer shall be excluded in case of defects and consequential damages resulting from incorrect assembly of this product.
- Please check the completeness of the delivered parts and check carefully if any transport damages are visible.
- If any parts are damaged or lost, please immediately contact the responsible supplier.
- It is assumed that you have exactly identified all cutting dimensions according to the measurement instruction for **raumplus** products.

SYMBOLE:

Symbol	Importance	Symbol	Importance
	Risk or danger!		During the installation do not use a striking tool
	Advice and information		No leverage tool for disassembly of fittings
	Additional information / other documents		Be aware of the risk of entrapment.
	Directional data / direction of movement		
	„yes“ and „right“		
	„no“ and „wrong“		
	Follow the order		

SYSTEM:

System Information: System 42 Serie1200

- max. weight of door = **30 kg**
- min./max. door height = **700 mm / 2750 mm**
- min./max. door width = **350 mm / 750 mm**

PRODUCT INFORMATION

GENERAL INFORMATION: **Product safety**

- The System complies with the prior of the art and the authorized safety rules at the time of delivery.

USE:

Intended use

- The prerequisite for the intended use of our products is the professional installation according to our installation instruction. Sufficient fittings must be available and durably installed to all relevant places. The function of the fittings must not be hindered or altered during installation.
- Special solutions are only possible in consultation with **raumplus**.

Incorrect use

- Risk or danger may occur in the following cases:
 - the door system has improperly been installed or maintained
 - the safety and installation instructions have not been followed.
 - after improper installation or inadequate fixing (e.g. to parts of buildings)
 - the maximum weight of the doors has been exceeded.
 - improper shock and case loads or other additional loads on the fittings have occurred
 - the fittings have been used outside.
 - body parts or objects got into the closing edges or door runnings during use of the door wing.
 - the door system is not used as intended.

Structural modifications

- Structural modifications that are not offered as an accessory from **raumplus** may only be attached or installed with permission of **raumplus GmbH!**

ACCESSORIES

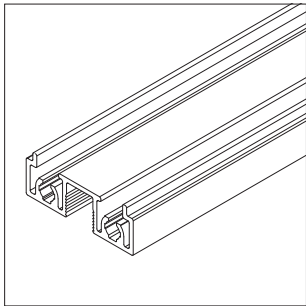

1_ 12.46.0xx

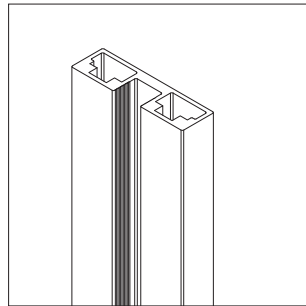

2_ 12.01.0xx

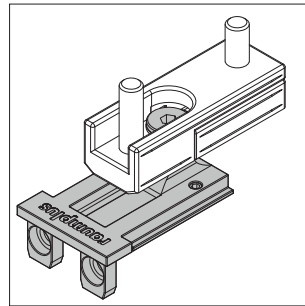

3_ 10.02.42x

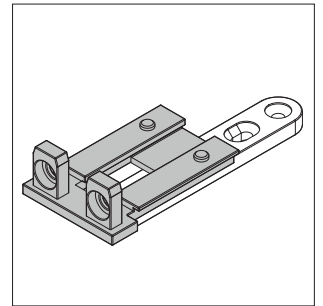

4_ 10.02.45x

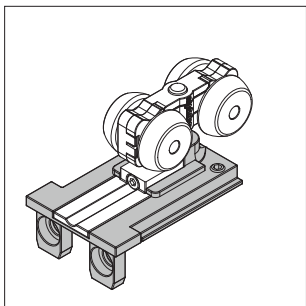

5_ 10.02.41x

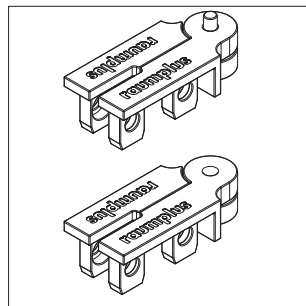

6_ 10.02.43x

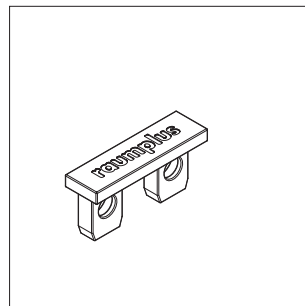

7_ 10.02.46x

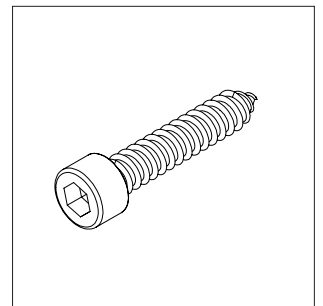

8_ 10.07.012

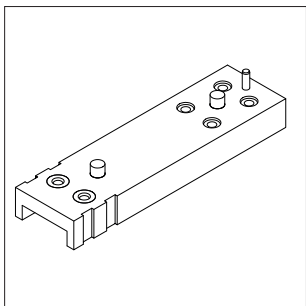

9_ 30.14.018

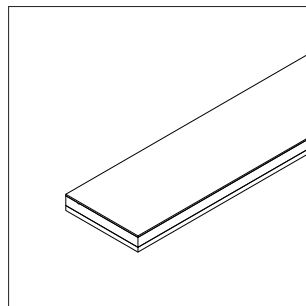

10_ 12.49.010

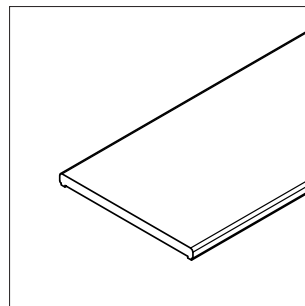

11_ 13.33.0xx

1_ rail folding-/hinge door S 1200

2_ stile S 1200

3_ pick up element set folding-/hinge door S 1200

4_ mounting plate set for folding-/hinge door S 1200

5_ top roller incl. pick up element, folding door S 1200

6_ folding door hinge set S 1200

7_ frame connector for folding-/hinge door S 1200

8_ frame screws 6,3 mm stainless steel (10.07.012)
 white head (10.07.212)
 black oxidized (10.07.213)
 silver mat stainless steel (10.07.214)
 bronze light (10.07.211)

9_ drilling template for S 1200

10_ magnetic tape self-adhesive

11_ dividing rail 28 mm

w/o. Illustration.:

12_ bottom track for magnetic profile silver (12.48.020)
 bronze light (12.48.040)
 bronze dark (12.48.050)
 white (12.48.060)
 black mat (12.48.065)

13_ countersink set w. guiding pin S 1200 (30.14.020)

14_ magnetic tape for bottom track (13.33.0xx)

15_ folding-/ hingedoor rail S 42 (12.45.0xx)

16_ Panel

17_ double sided tape for dividing rail (25.12.045)

EXPLODED DRAWING

DIN LEFT

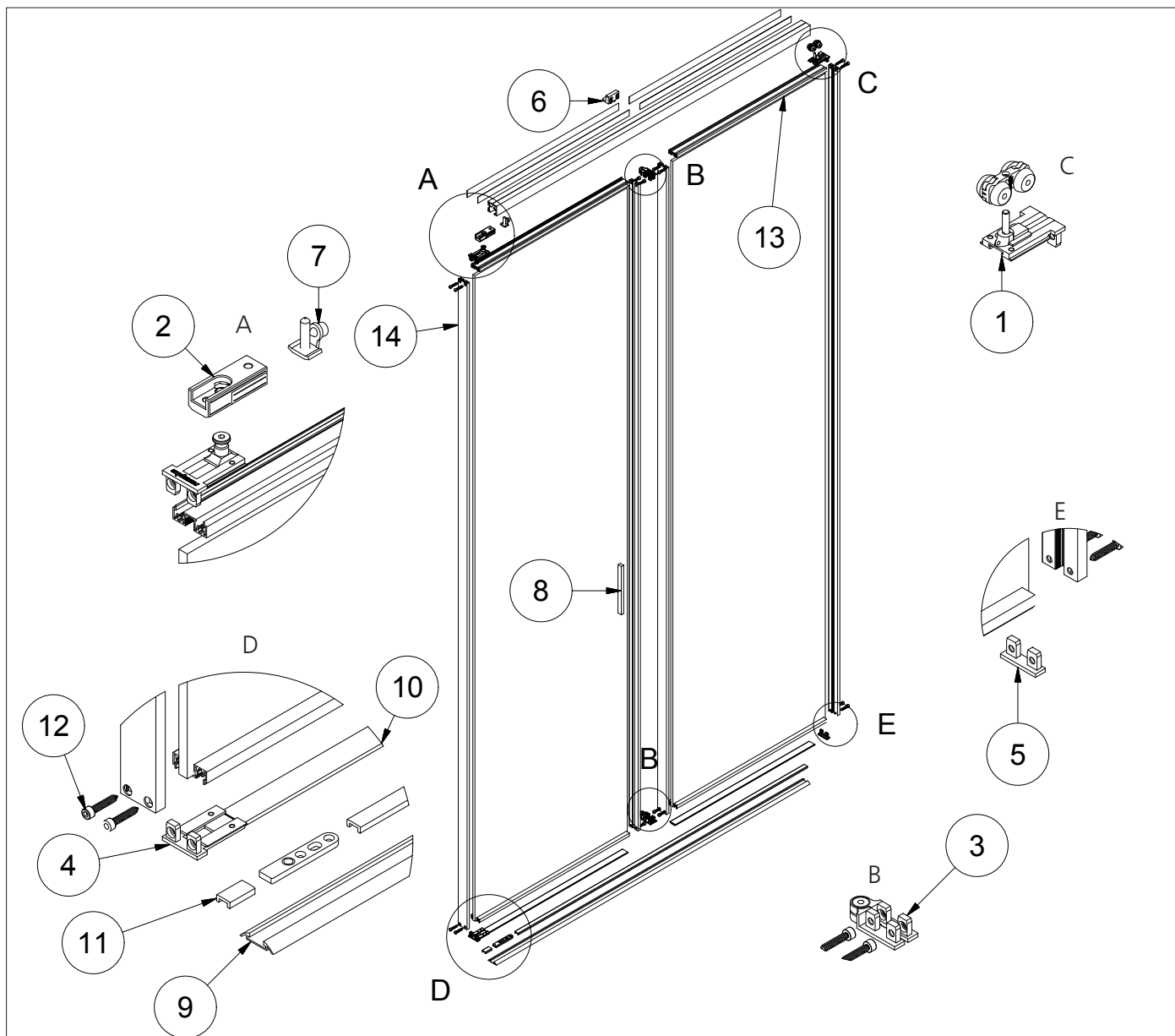

Parts list			
Object	Quantity	Description	Item number
1	1	top roller incl. pick up element, folding door S 1200	10.02.41x
2	1	pick up element set for folding-/hinge door S 1200	10.02.42x
3	1	folding door hinge set S 1200	10.02.43x
4	1	mounting plate set for folding-/hinge door S 1200	10.02.45x
5	1	frame connector for folding-/hinge door S 1200	10.02.46x
6	1	top positioning for folding-/hinge door S 1200	10.02.470
7	1	stopper for top track	10.02.480
8	1	cube handle for hinge and folding doors	10.01.93x
9	1	bottom track for magnetic profile	12.48.0xx
10	2	magnetic tape self-adhesive	12.49.010
11	1	magnetic tape for bottom track	12.49.015
12	16	frame screws 6,3 mm stainless steel	10.07.0xx
13	4	rail folding-/hinge door S 1200	12.46.0xx
14	4	stile S 1200	12.01.0xx

1_ Complete folding door **DIN Left**

DETAIL DRAWING

PREPARING STILES / CUTTING DIMENSIONS

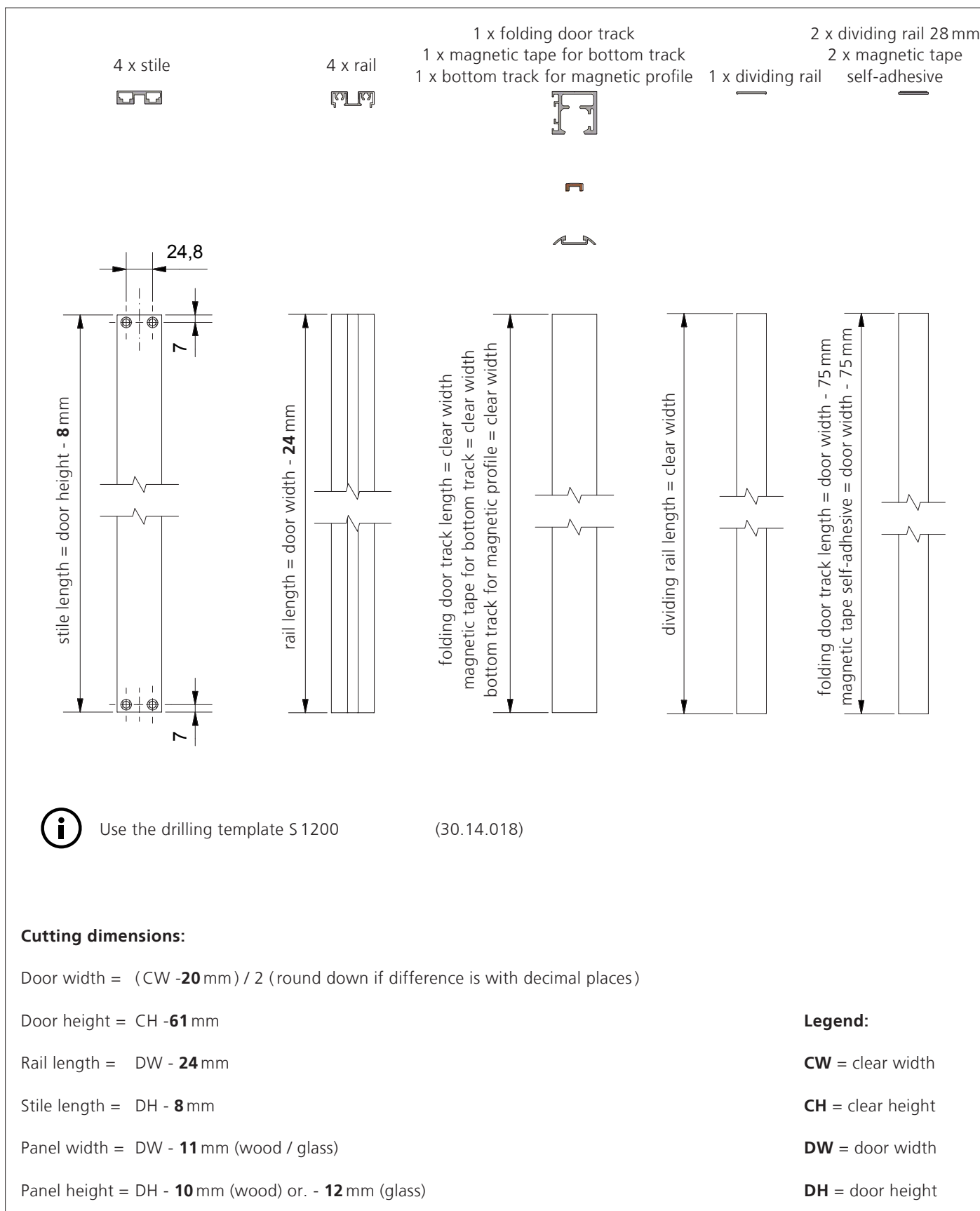

DETAIL DRAWING

DIN LEFT

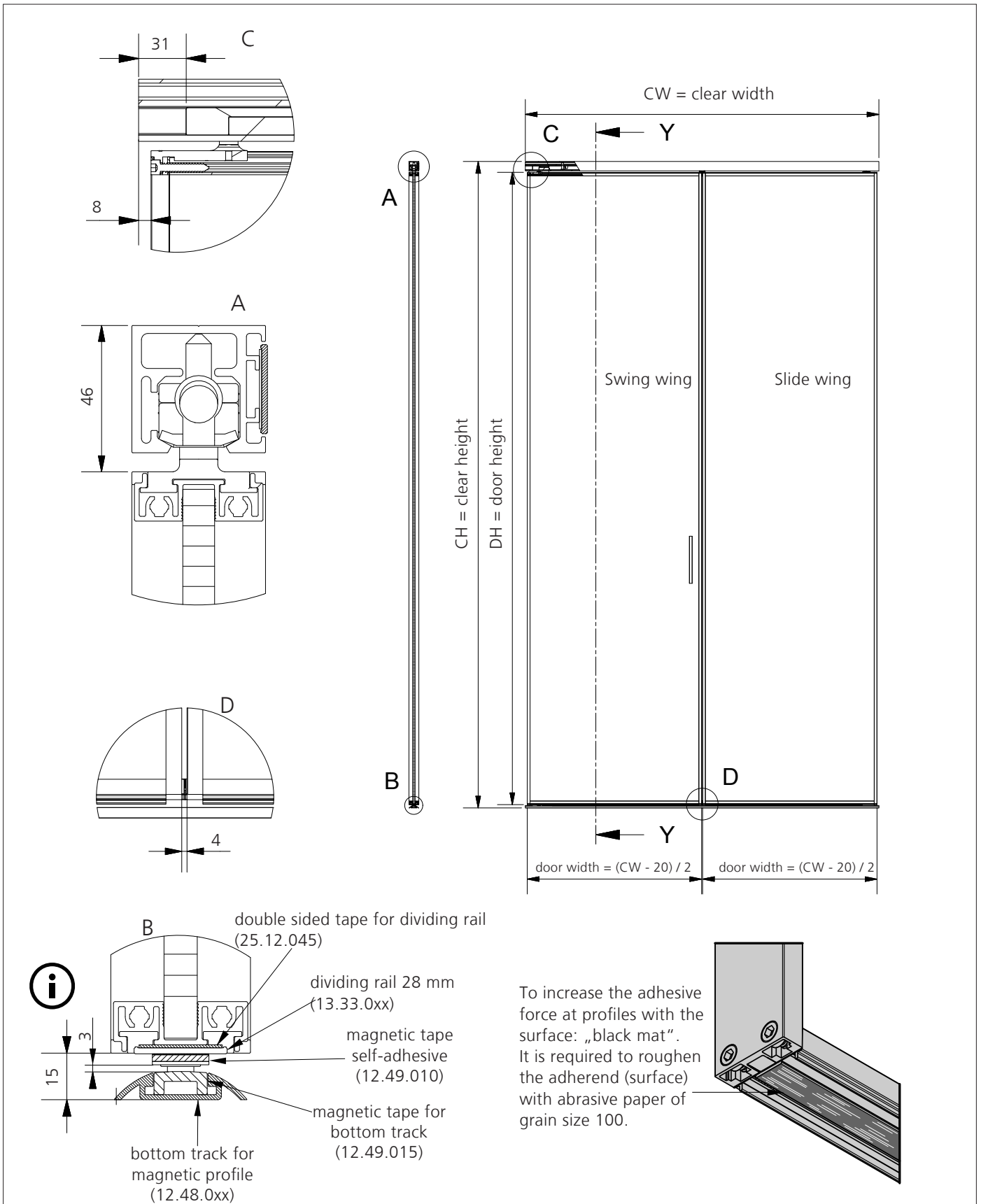

DETAIL DRAWING

HINGE DIN LEFT / DIN RIGHT

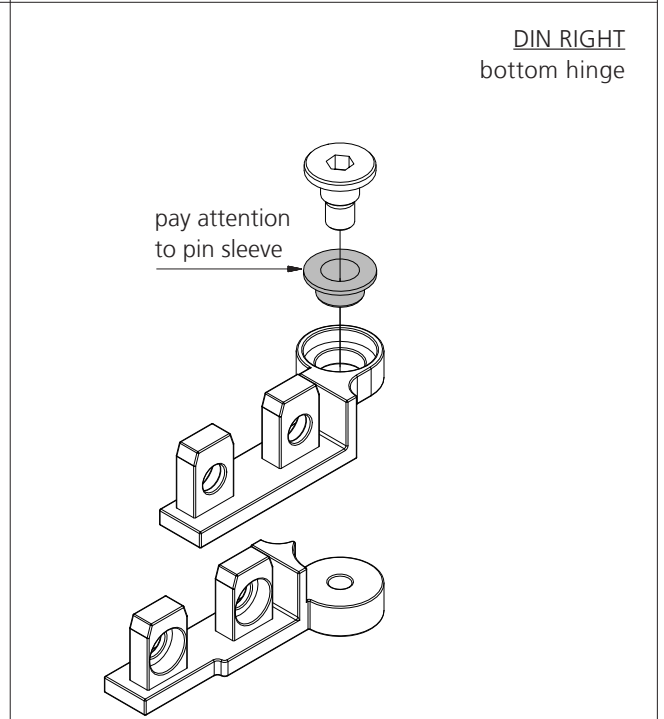
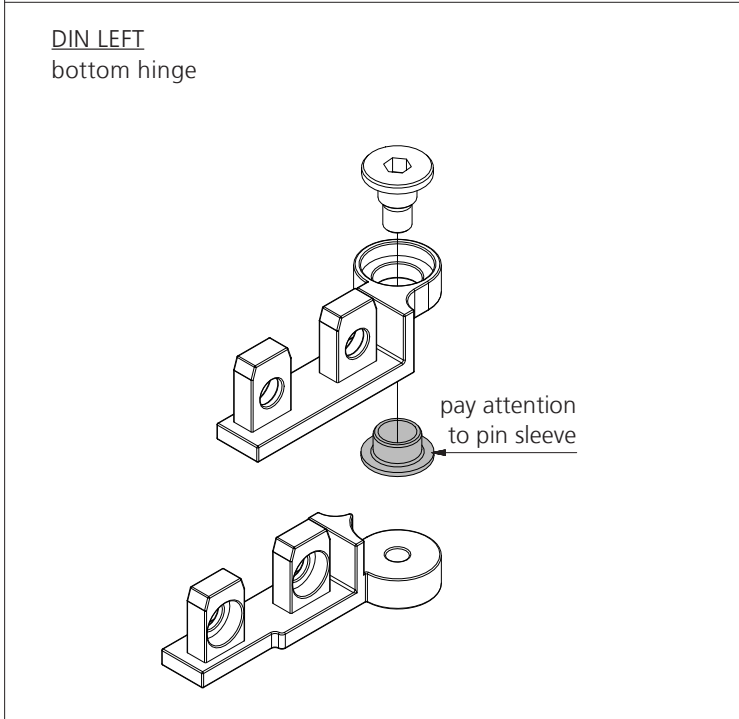
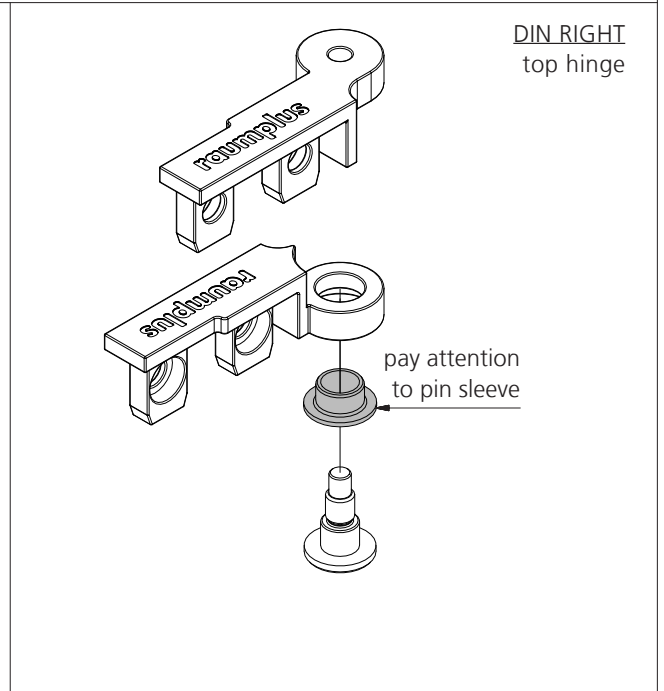
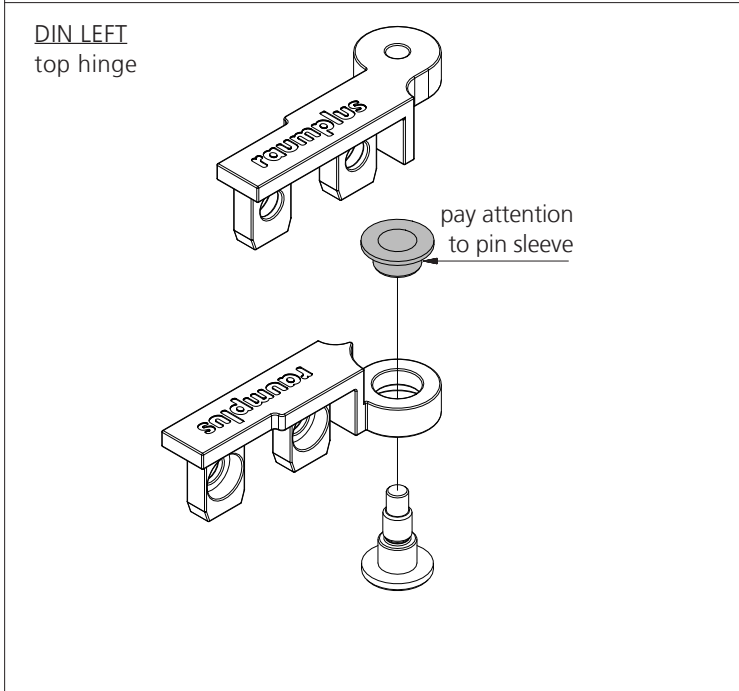
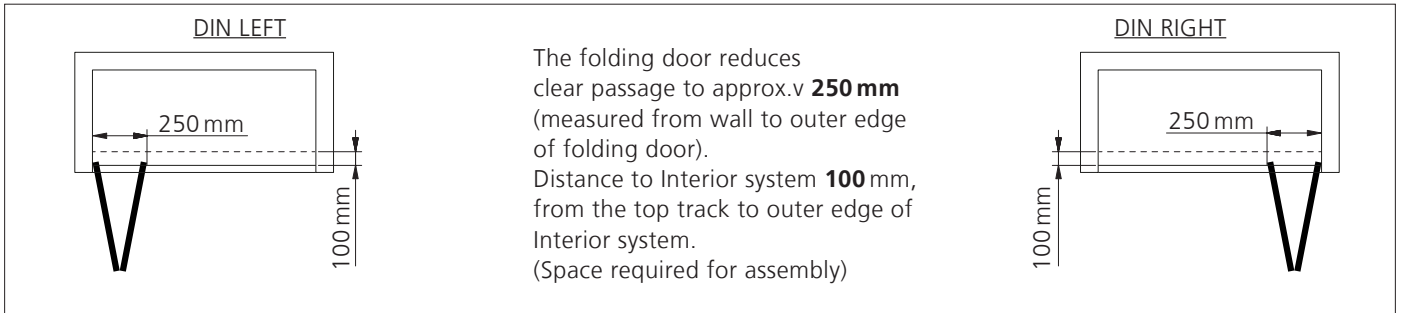

ASSEMBLY INSTRUCTION

DIN LEFT – SLIDE WING AND SWING WING

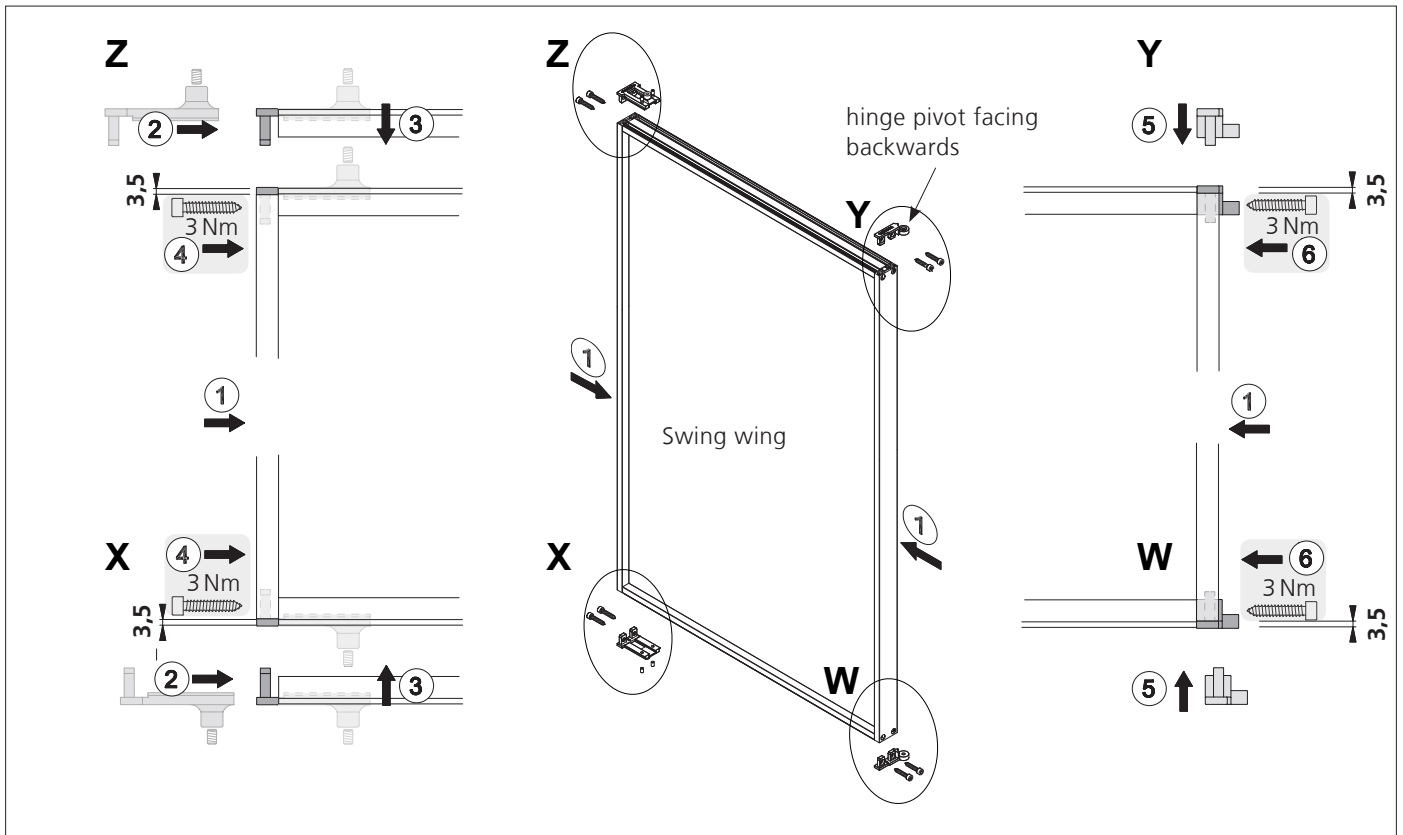

1_ Swing wing (DIN LEFT), be carefull with the fittings!

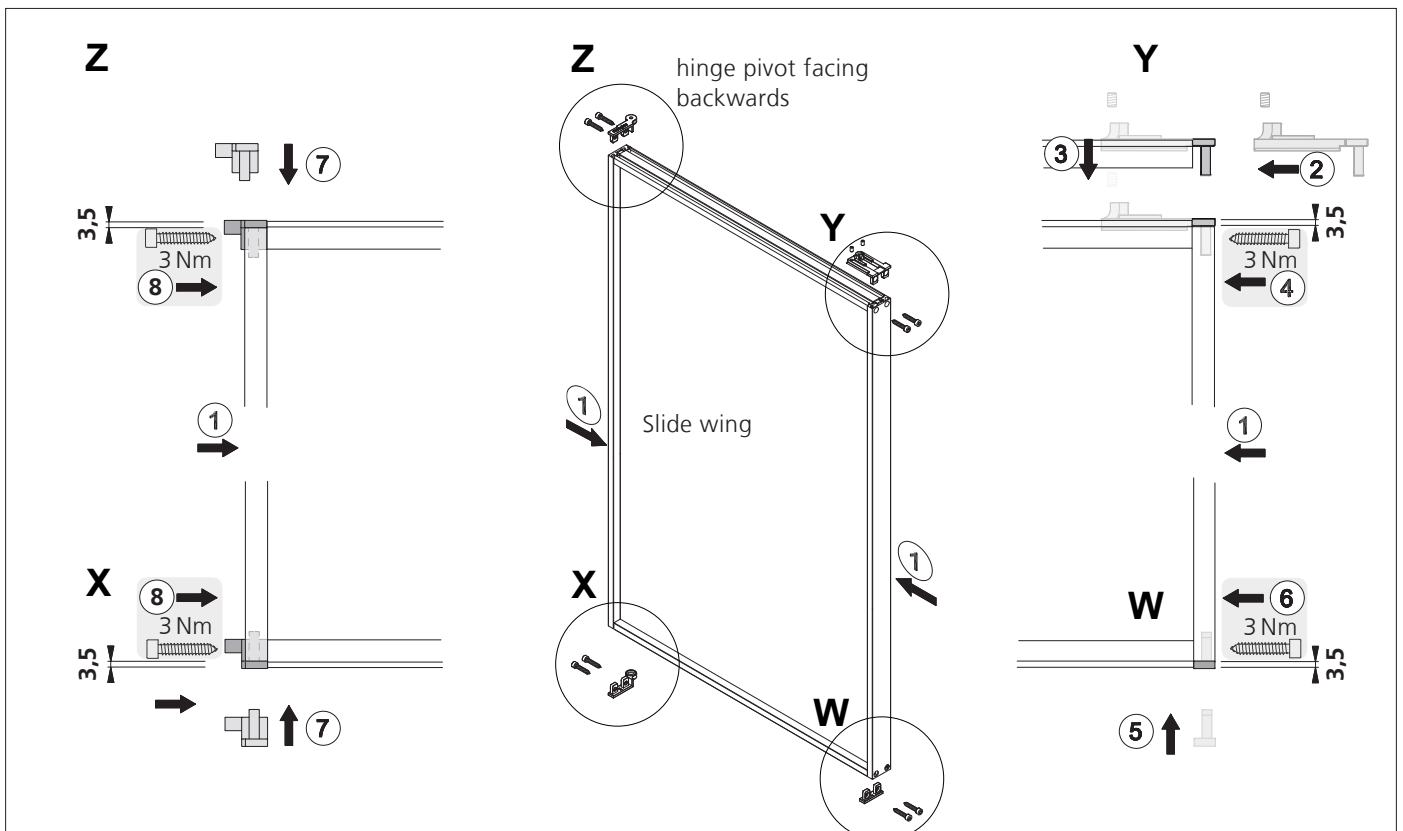

2_ Slide wing (DIN LEFT), be carefull with the fittings!

ASSEMBLY INSTRUCTION

DIN LEFT

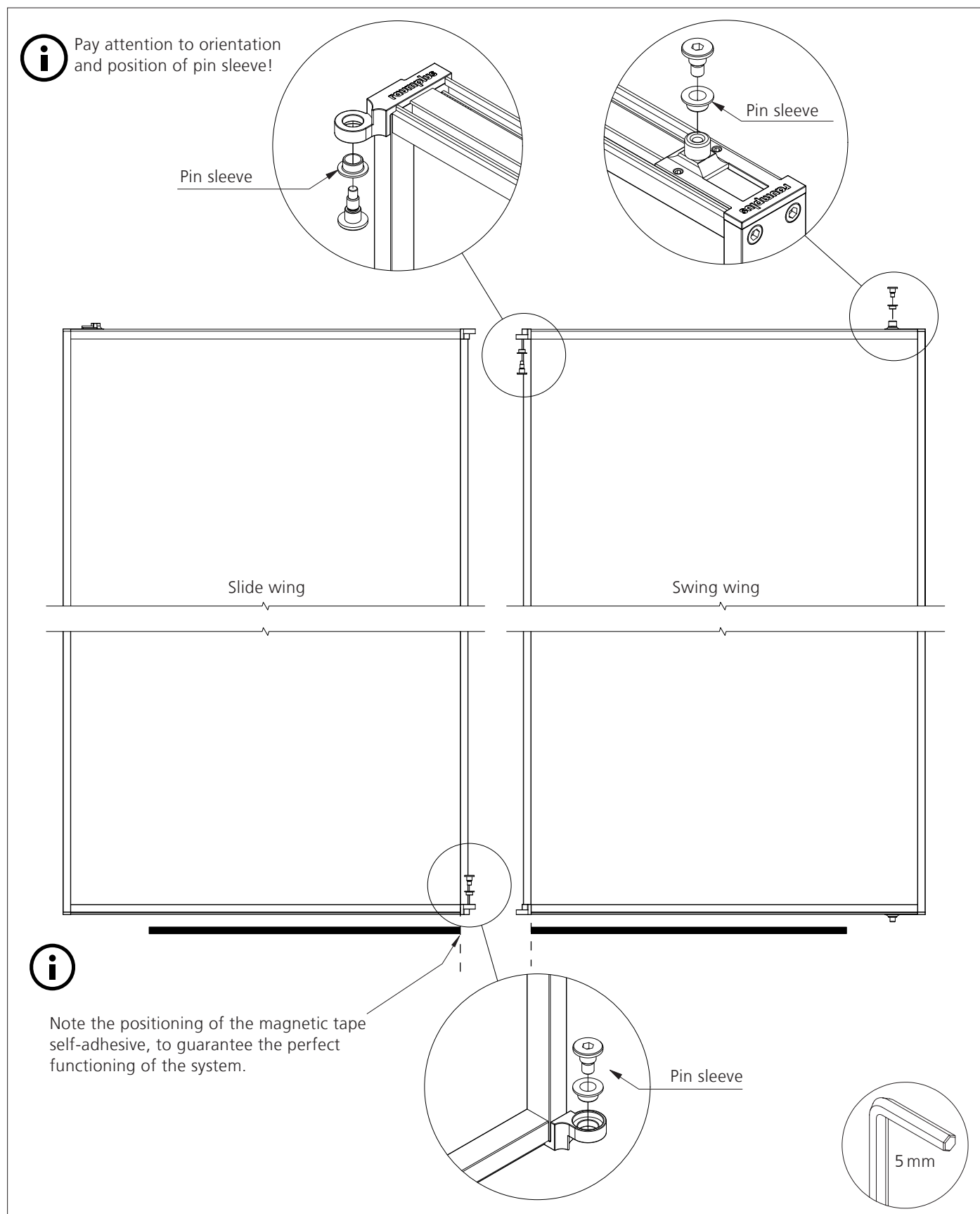

3_ Swing wing and slide wing (fi. back **DIN LEFT**)

Customer:	
Commission:	
Order processing No.:	

Construction: 2 elements

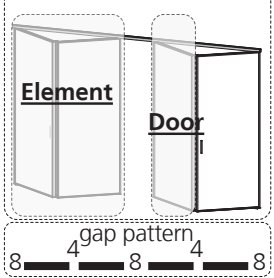

Cutting dimensions for S 1200 folding door with magnetic rail				
Series	Door height: deduction of clear height min: 700 mm max: 2750 mm	Door width: deduction of clear width min: 700 mm max: 1500 mm	Panels	
			deduction of door width with / without gasket	deduction of door height with / without gasket
S 1200	61 mm	20 mm / 2*	11 mm	10 mm 12 mm

*Round down if difference is with decimal places!

Surface profiles: _____

panel: _____ handle: _____

- 1 Stile length = $dh - 8$ mm

- 2 Rail length = $dw - 24$ mm

- 2a Dividing rail length = $dw - 75$ mm

- 2b Magnetic tape self-adhesive length = $dw - 75$ mm

- 3 Folding door track length = cw

- 3a Dividing rail length = cw

- 4 dividing rail length = $dw - 24$ mm

- 5 Bottom track for magnetic profile length = cw

- 5a Magnetic tape for bottom track length = cw

Door with left-hand hinge

Door with right-hand hinge

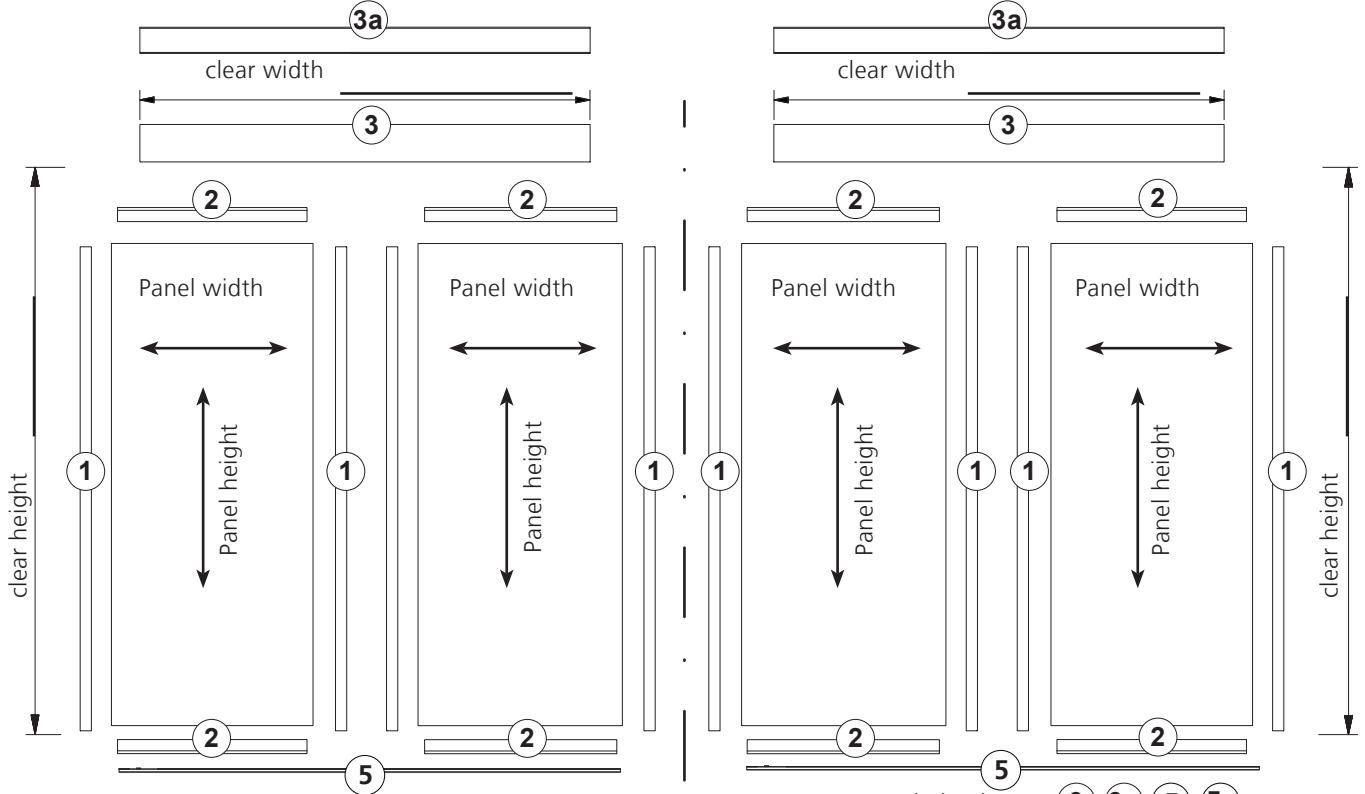

Processor:
Name, Date _____

*Regularly, the pos 3 3a 5 5a is 100 mm longer, please delete if not required.