

SWING DOOR / SWING DOOR SLIM LINE: ATTACHMENT: HANDLE WITH MAGNETIC LOCK

Version 1.2 (2018-06-01)

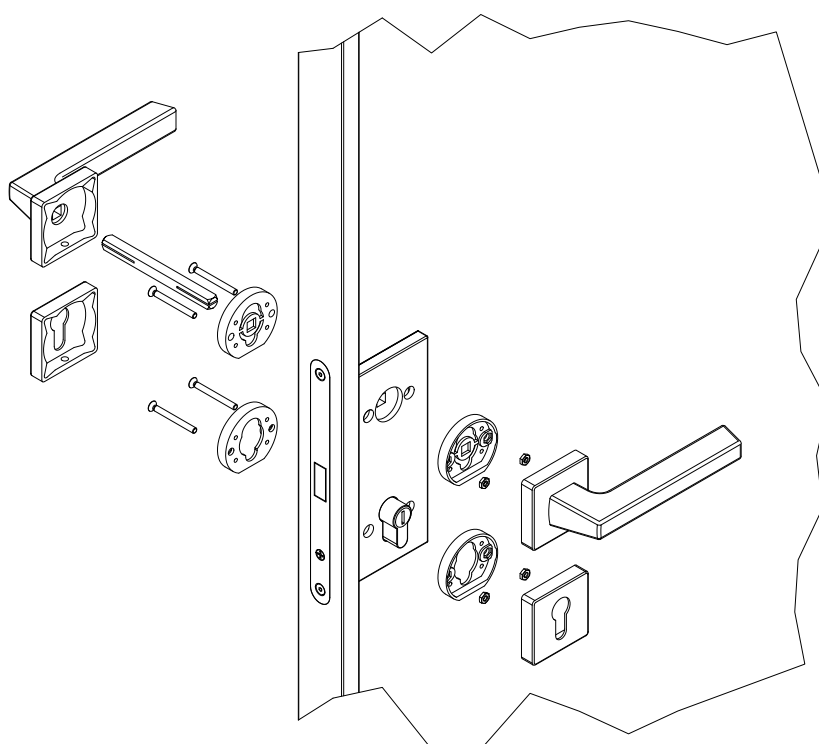

2.991.c

easy medium difficult

Assembly



subject to technical changes.

raumplus

CONTENT AND TOOLS

CONTENT:

| | | |
|---|------|----|
| Content and tools | page | 02 |
| Accessories | page | 03 |
| Lever Handle Set | page | 04 |
| Swing door overall view | page | 05 |
| Door frame Swing door milling pattern | page | 06 |
| Swing door slim line overall view | page | 07 |
| Door frame Swing door slim line milling pattern | page | 08 |
| Milling pattern stile interior door | page | 09 |
| Milling pattern panel | page | 10 |
| Assembly | page | 11 |
| Frame and locking plate | page | 13 |
| Particularities locking plate | page | 14 |

TOOLS:

(without claim of completeness)

- Aluminium saw
- Allen keys set
- Drills set
- Cross tip screwdriver
- Electric drill
- Cordless screwdriver
- Screwdriver set
- Pencil
- Milling machine
- Straight edge
- mounting glue



VERSION INFORMATION:

Version 1.0: Product launch.
" 1.1: Milling pattern stile door and panel added.
" 1.2:

ACCESSORIES

HANDLE WITH MAGNETIC LOCK

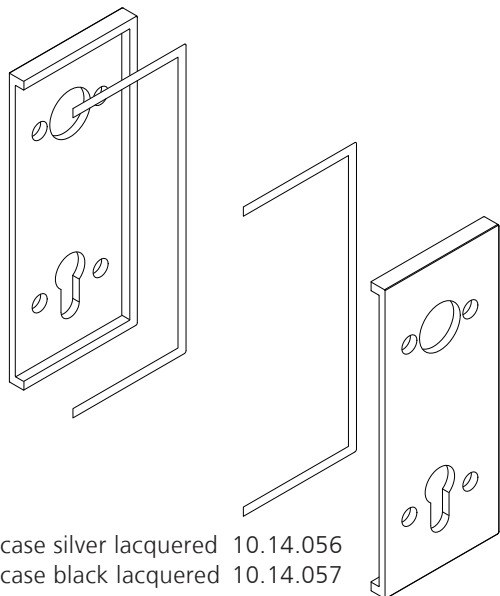

Lock case silver lacquered 10.14.056
Lock case black lacquered 10.14.057

Profile cylinder nickel mat 10.14.054
Profile cylinder bronze sat. 10.14.055

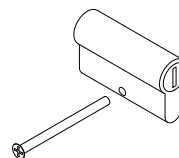

Cylinder screw nickel mat
Cylinder screw bronze sat.

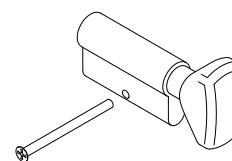

Privacy knob cylinder nickel mat 10.14.061
Privacy knob cylinder bronze sat. 10.14.062

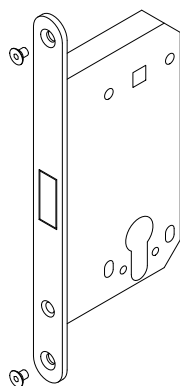

Magnetic lock nickel mat 10.14.050
Magnetic lock black 10.14.051

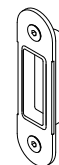

Locking plate f. magnetic lock nickel mat 10.14.052
Locking plate f. magnetic lock black 10.14.053

LEVER HANDLE SET

EXPLODED DRAWING

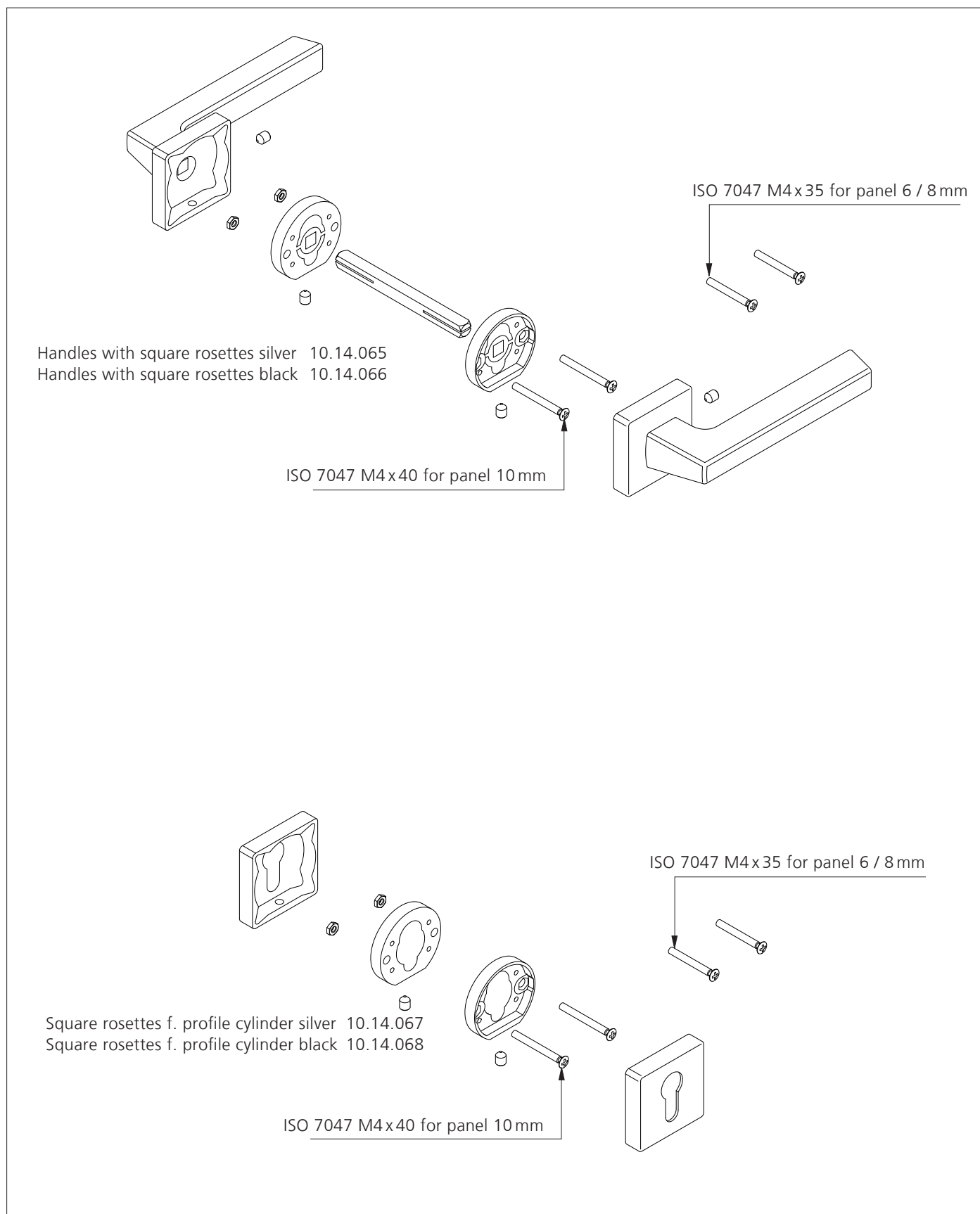

SWING DOOR OVERALL VIEW

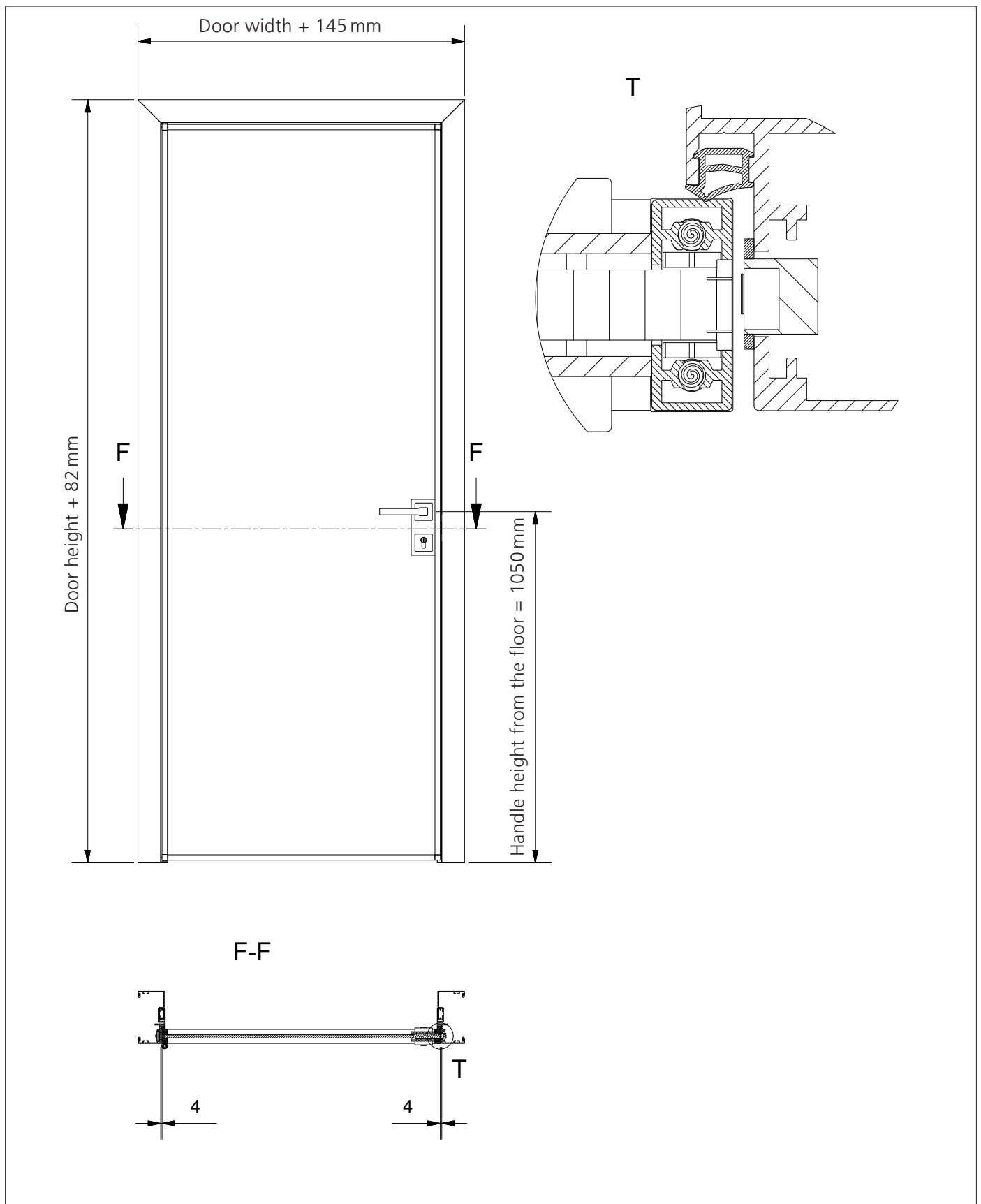

DOOR FRAME SWING DOOR MILLING PATTERN

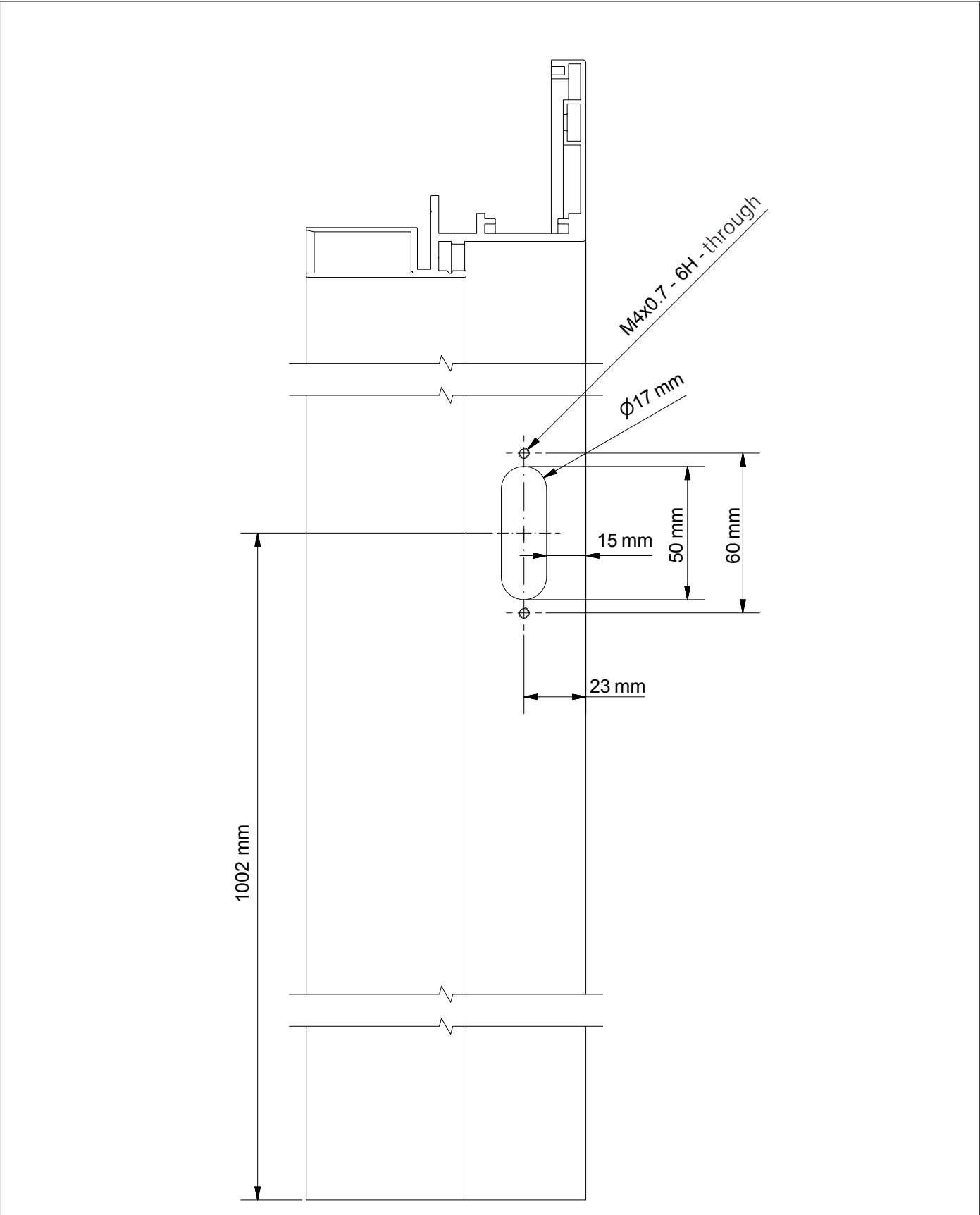

SWING DOOR SLIM LINE OVERALL VIEW

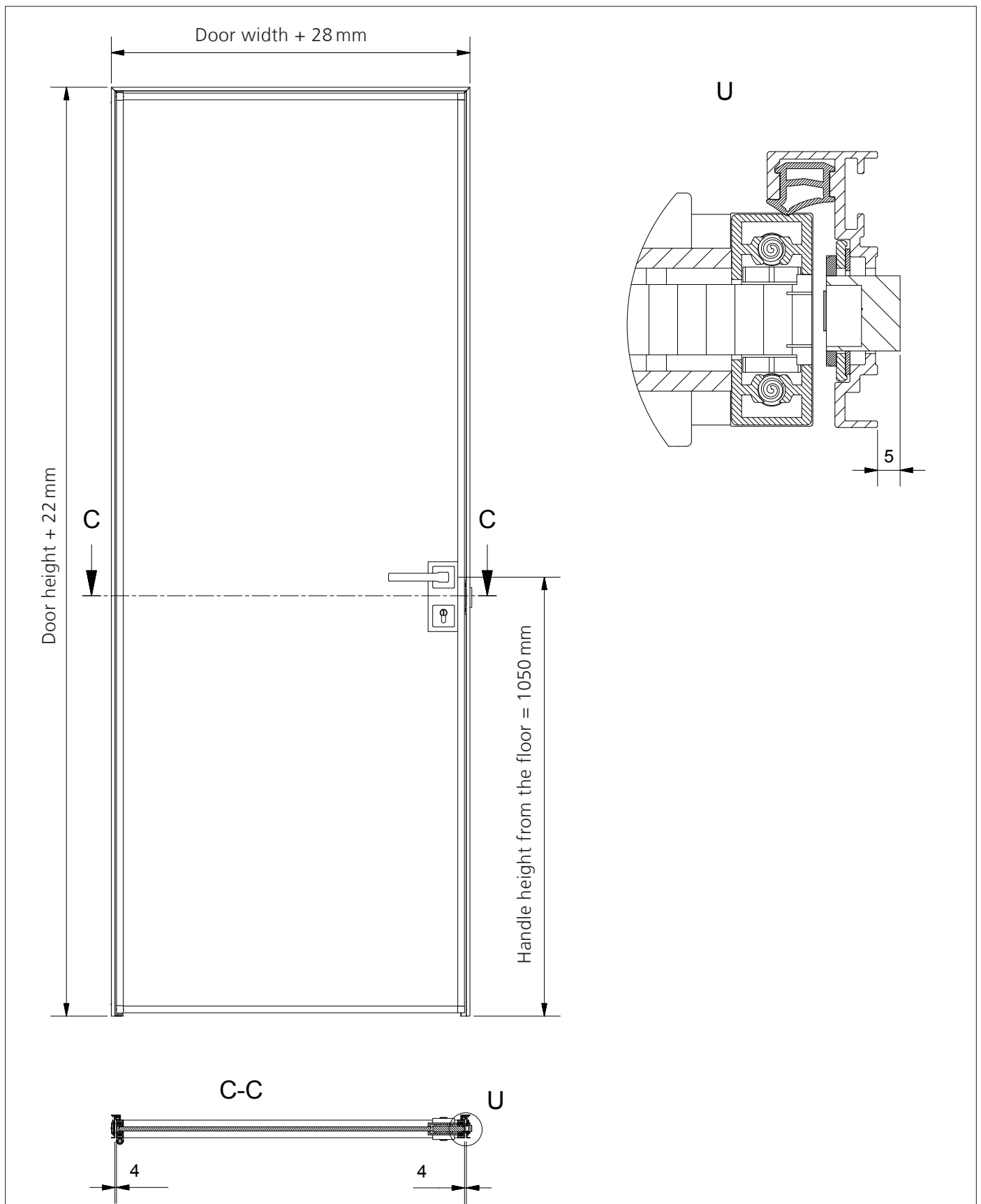

DOOR FRAME SWING DOOR SLIM LINE MILLING PATTERN

Door frame Swing door slim line

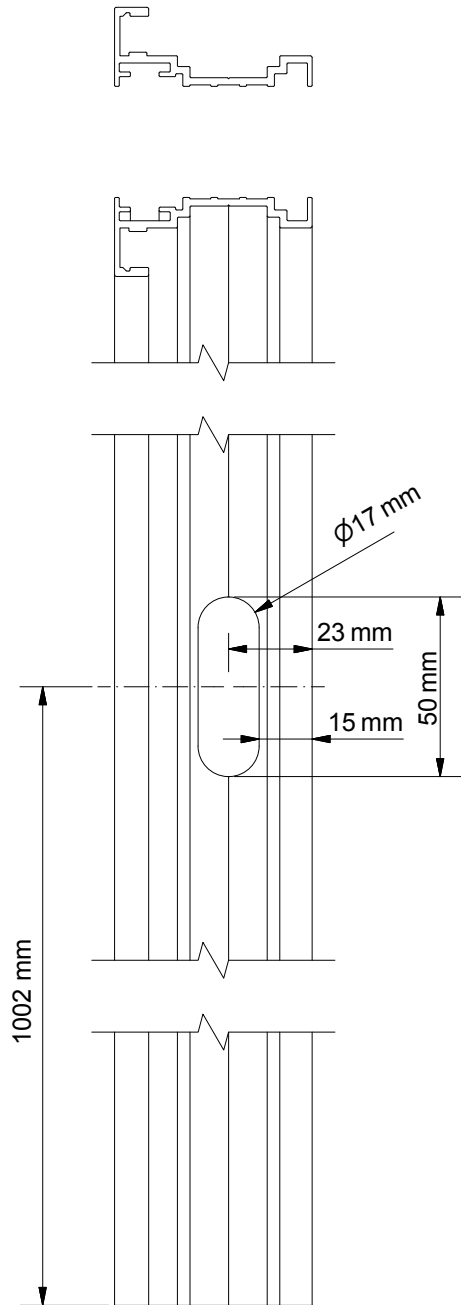

Dividing rail 28 mm

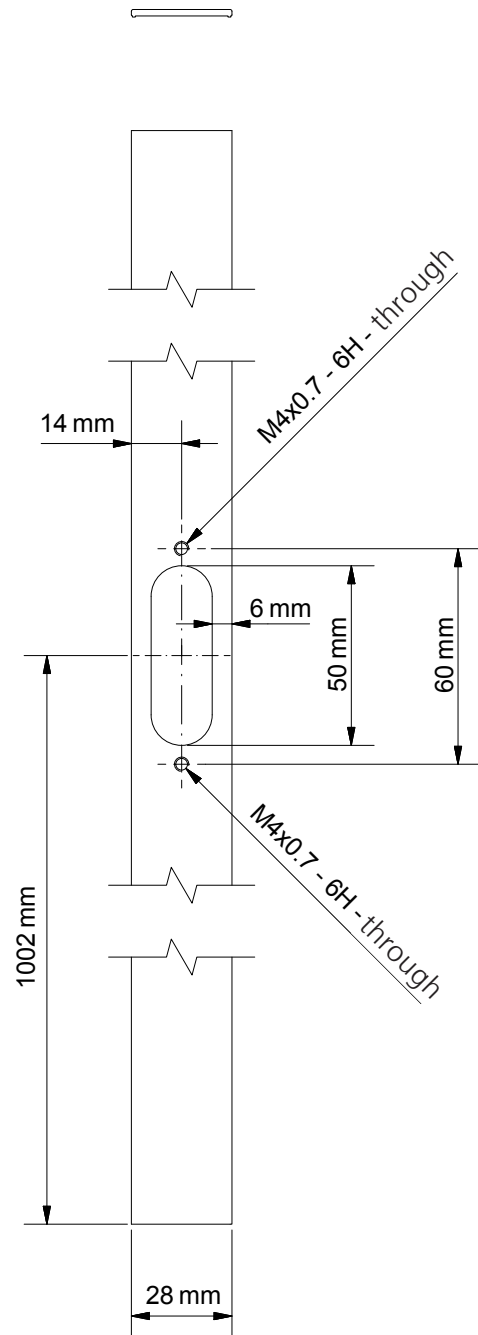

STILE INTERIOR DOOR MILLING PATTERN

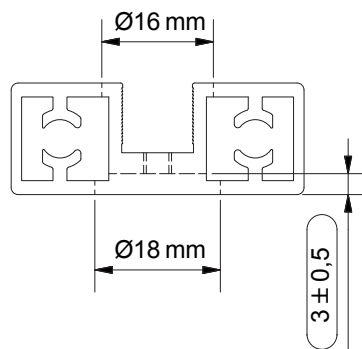
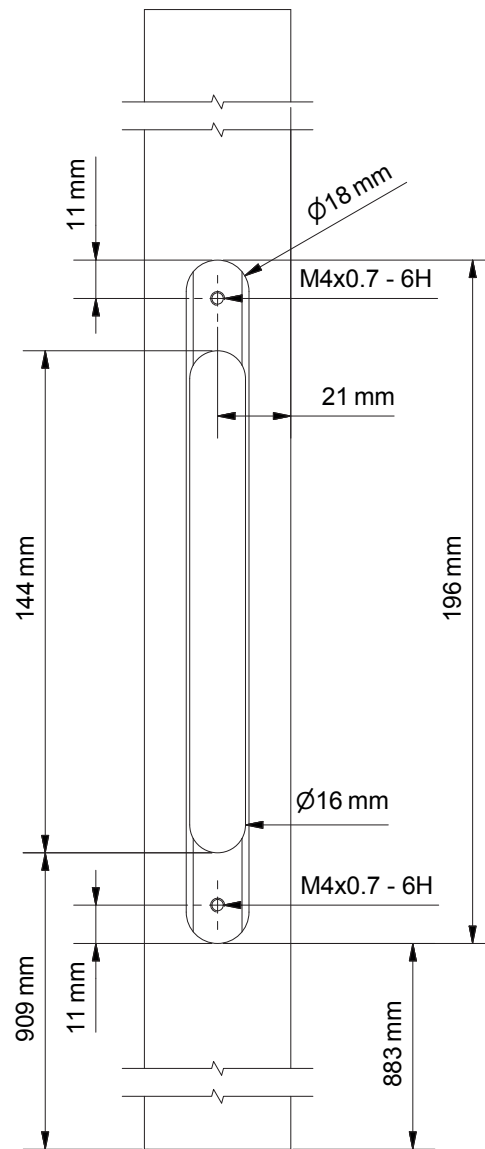

PANEL MILLING PATTERN

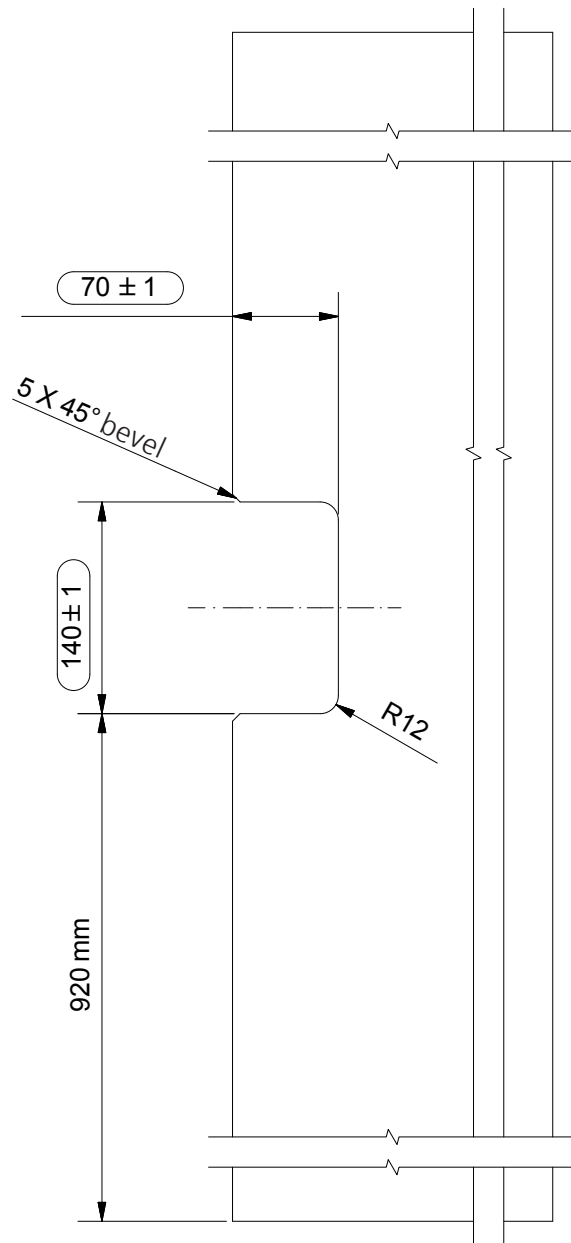

ASSEMBLY

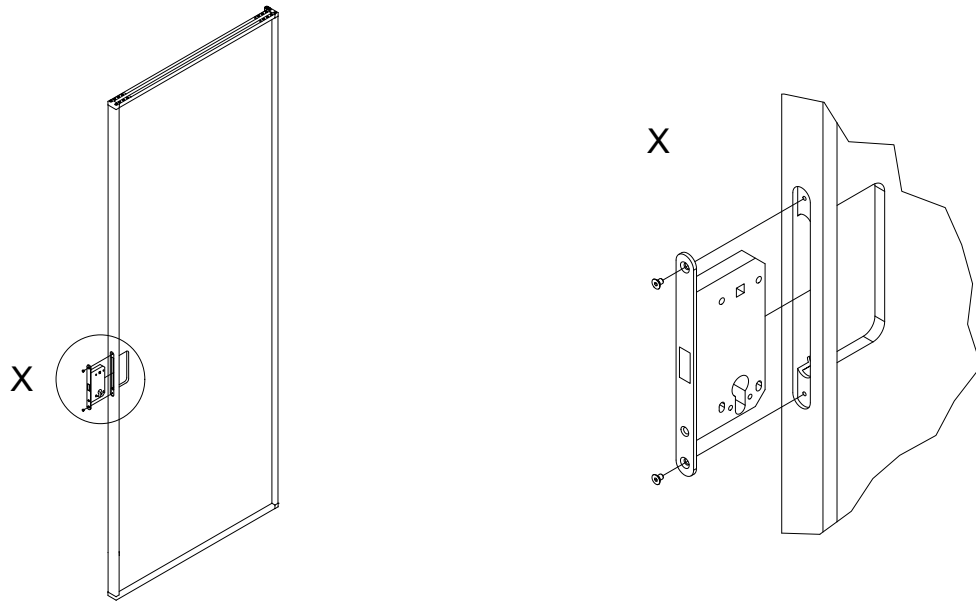

| part list | | | |
|-----------|----------|-------------|---------------|
| object | quantity | item number | description |
| 1 | 1 | 10.14.050 | magnetic lock |

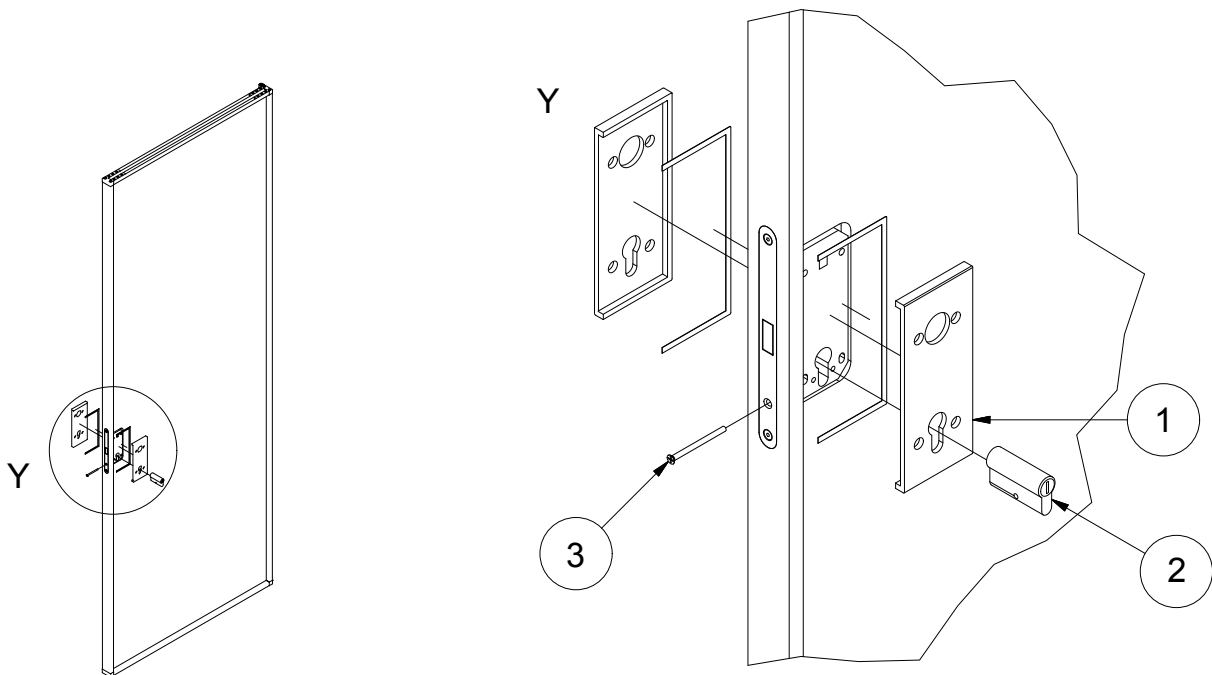

| part list | | | |
|-----------|----------|-------------|----------------------------|
| object | quantity | item number | description |
| 1 | 2 | 10.14.056 | lock case silver lacquered |
| 2 | 1 | 10.14.05x | profile cylinder |
| 3 | 1 | 10.14.055A | cylinder screw M5 x 55 |

ASSEMBLY

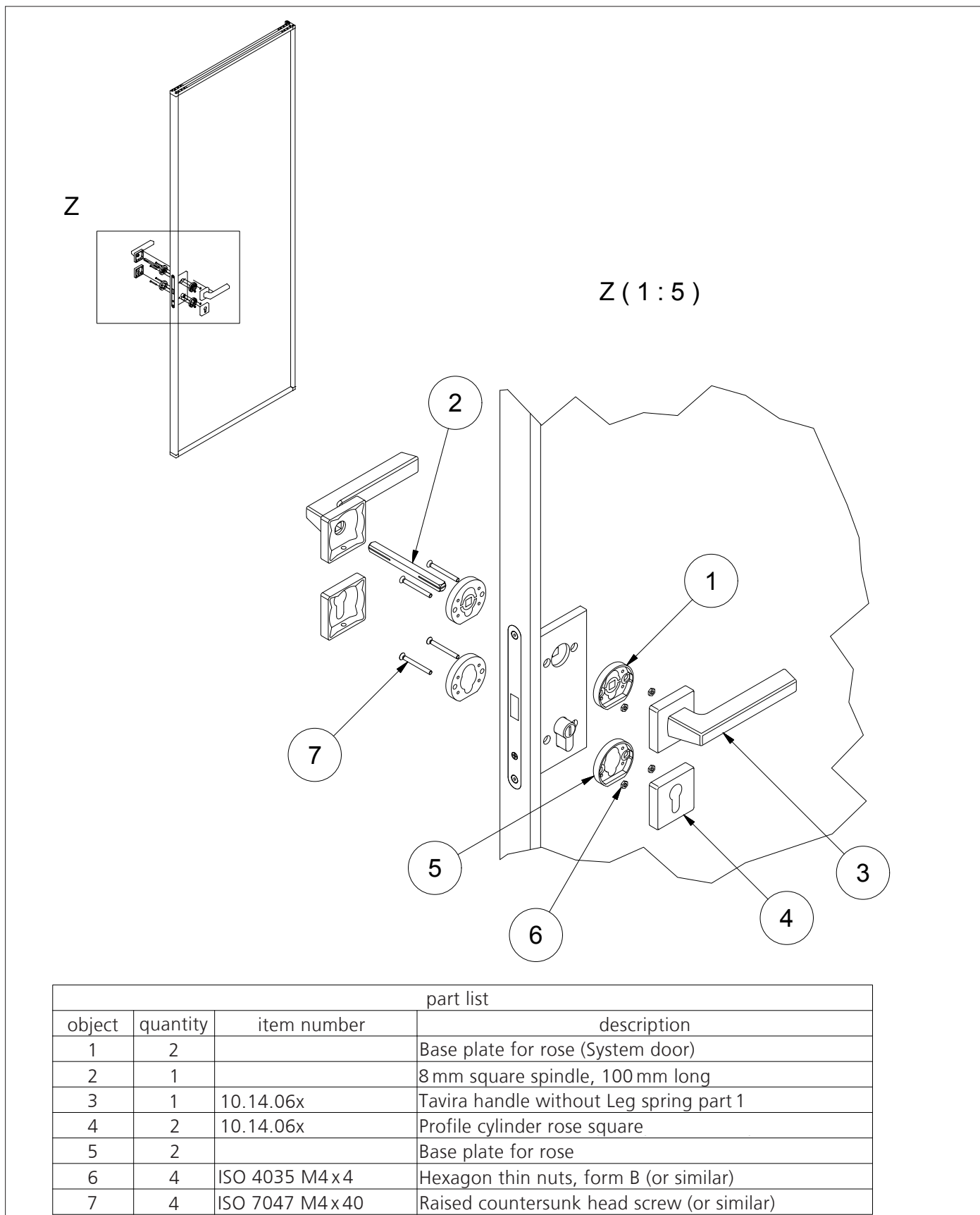

FRAME AND LOCKING PLATE

SWING DOOR SLIM LINE
FRAME

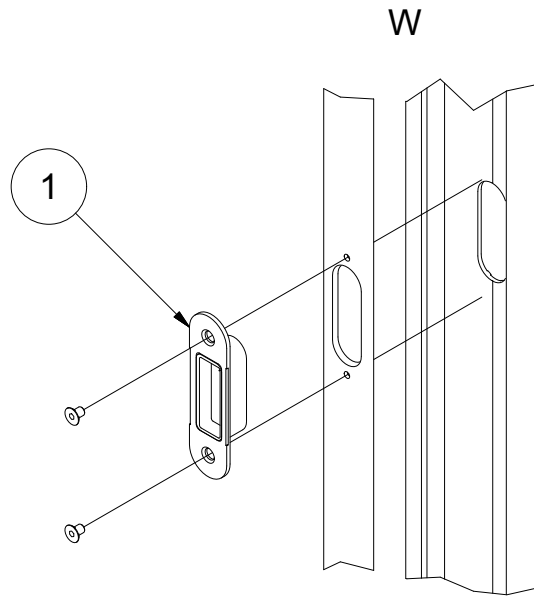
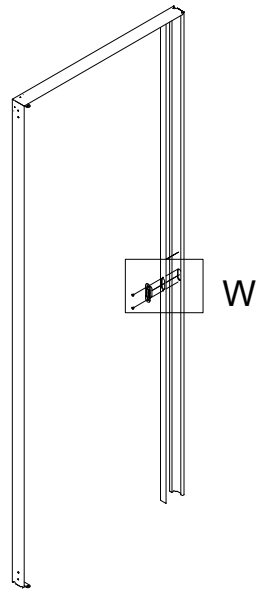

| part list | | | |
|-----------|----------|-------------|--------------------------------|
| object | quantity | item number | description |
| 1 | 1 | 10.14.05x | locking plate f. magnetic lock |

SWING DOOR
FRAME

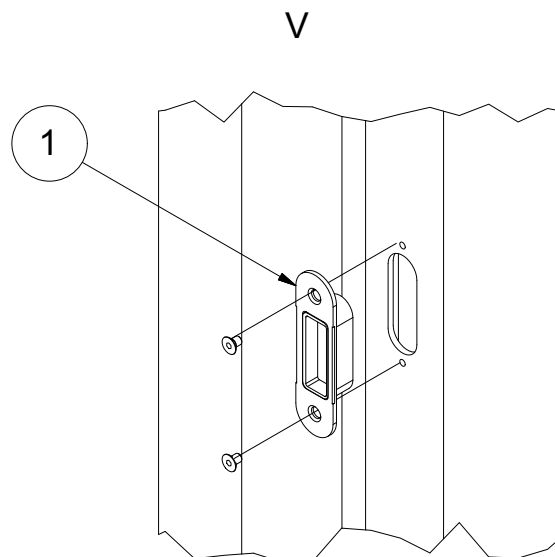
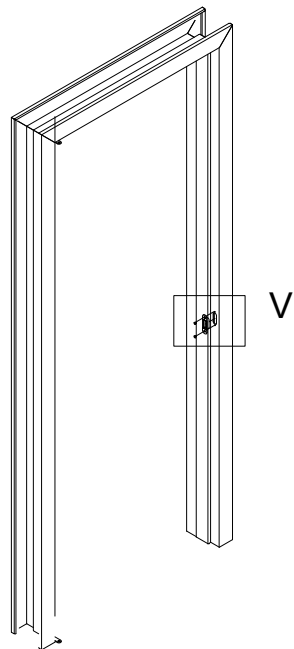

| part list | | | |
|-----------|----------|-------------|--------------------------------|
| object | quantity | item number | description |
| 1 | 1 | 10.14.05x | locking plate f. magnetic lock |

PARTICULARITIES

The locking plate consists of the sheet metal part and magnets.
The two parts must be glued.



Clean the adhesive surfaces of grease, oil or silicone films, as well as dirt particles.
Use lint-free cloths and cleaners.

For gluing you can use:
Innotec Topfix;
mounting glue, silicone or acrylic sealant

Area for gluing

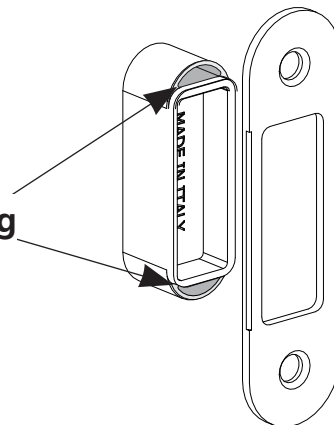

Mounting:

You can turn the striker plate by 180° to get a higher fit between strikerplate and deadlock door lock.

